



TECHNICAL SPECIFICATIONS

Customized software	MoBus Protocol
Input voltage	100~240 VAC - 50/60Hz (SMPS)
Output voltage	29 VDC - 7A total
Number of actuators	Maximum 4 inputs
Number of controls	1 input
Protections	-Overload protection -Overheat protection
Compatibility	-Actuators: V10/V221/V3M/V31/V60/V66/V7/V80E/ V82 -Controls: H3T-M / HS12-M / CP1 / CP2 -Accessories: battery back-up CBVB3 / stop button SB1
Protection grade	IP66
Protection class	Class II
Standby power	< 0.5W
Power On indicator	LED
Battery charging function	for external backup battery
Colour	Light grey (RAL 7035)
Duty cycle	10% (2 mn operation / 20 mn rest)
Standard certifications	CE Marking/ Medical Device Directive 93/42/EEC

DIMENSIONS

Unit: mm

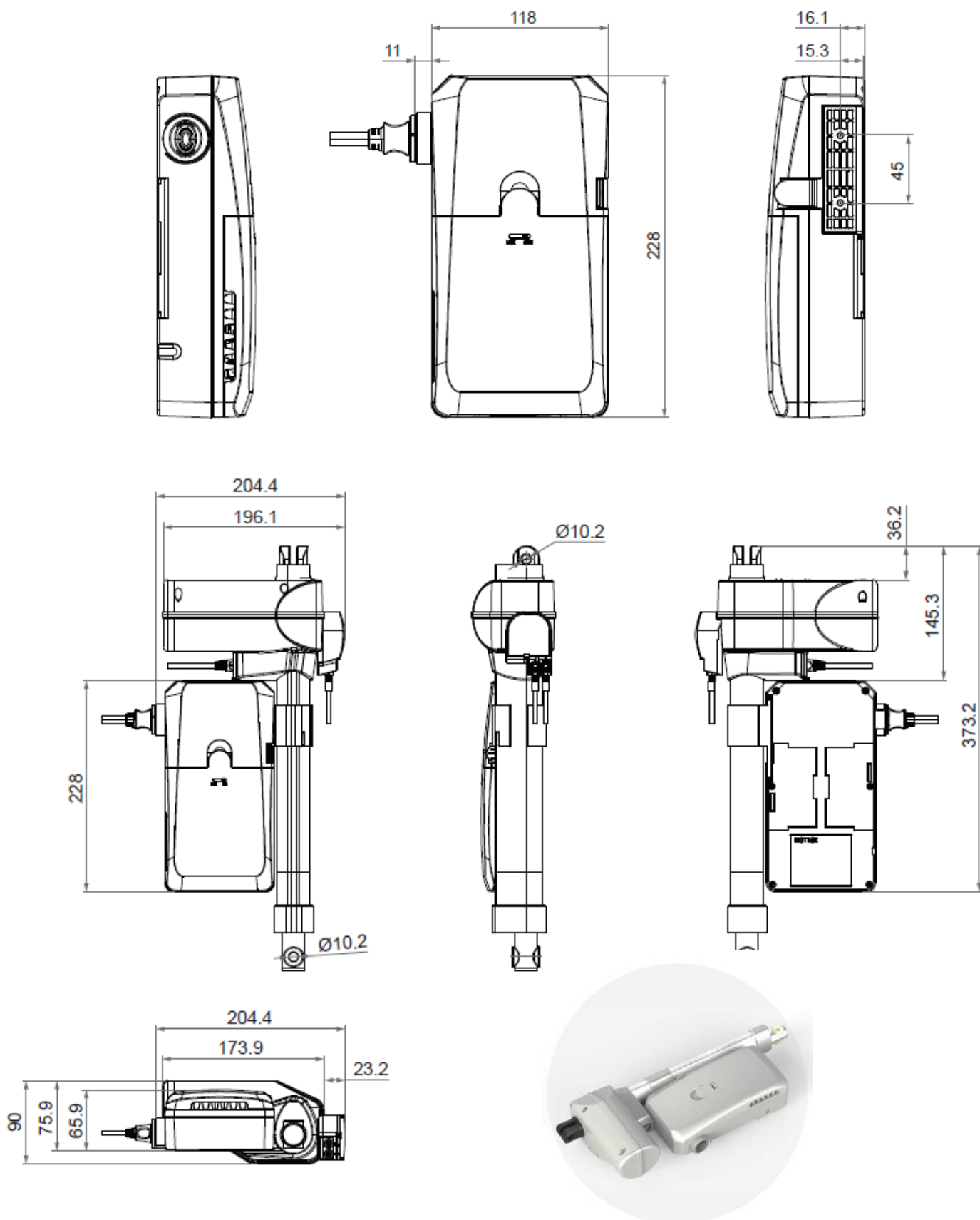

Remarks :

- the BC41 control box is designed to be hooked up on the actuator V31 as an integrated set,
- for the other actuators (V10, V221, V3M, etc.) the BC41 control box is separated from the actuator.

ACTUATOR AND CONTROL CONNECTIONS

1-to-4 model

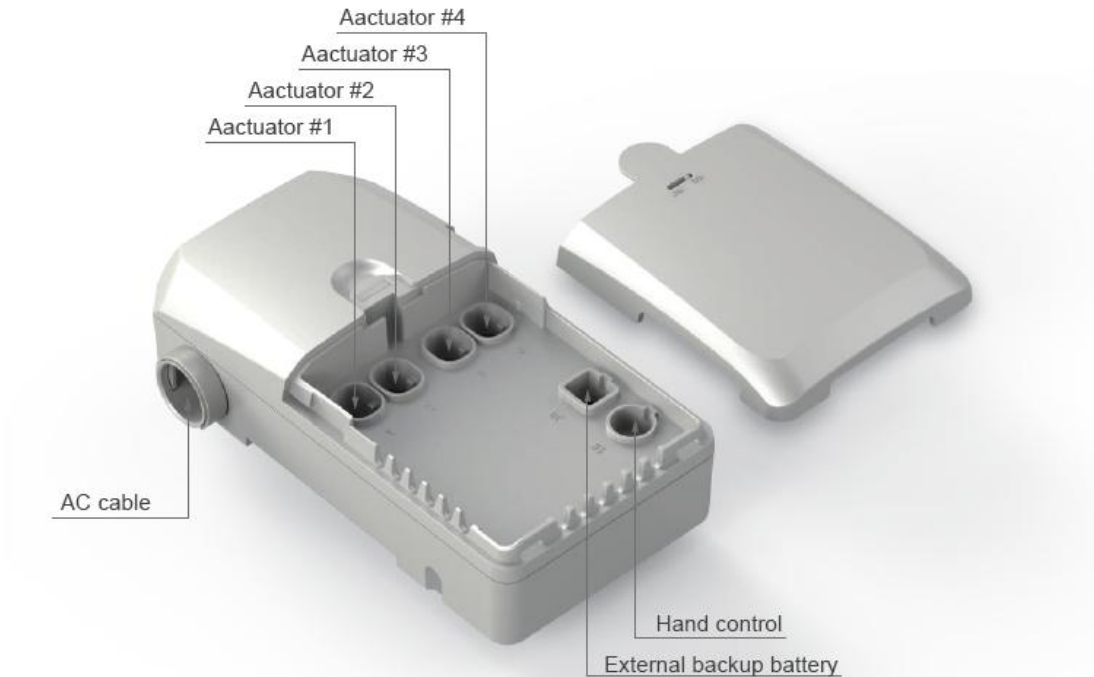

CABLE CONNECTORS

Actuator socket for LR-type minifit 6-pin plug

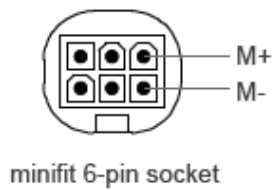

LR-type

Hand control socket for V-type 7-pin DIN plug

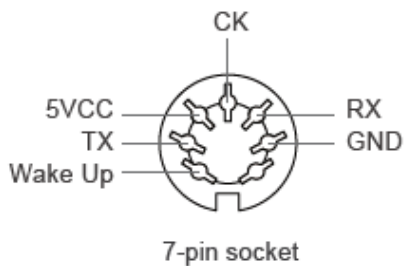

V-type

Backup battery socket for L6-type minifit 4-pin plug

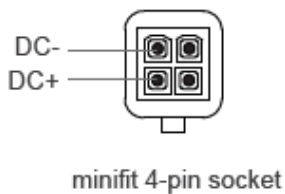

L6-type

MoBus™ family

