

Desk Lifting Column CLK3



TECHNICAL SPECIFICATIONS

Transmission type	3-section mechanism
Input voltage	24 VDC-32 VDC
Push Maximum Strength	800 N
Stroke	650 mm
Speed with 24 VDC power supply	Maximum without load = 45 mm/sec. Maximum at full load = 26 mm/sec.
Speed with control box BCK3 32 VDC	Maximum without load = 30 mm/sec. Maximum at full load = 28 mm/sec.
Positioning feed-back	Dual hall effect sensors
Connector type	Minifit 6-pin 180° plug
Noise level	< 50 dB
Duty Cycle	10% (max. 1 mn continuous operation in 10 mn)
Protection Grade	IP20
Compatibility Control Box	BCK3

Options :

Length of power cord	Straight 1200 mm or 2000 mm
----------------------	-----------------------------

PERFORMANCES

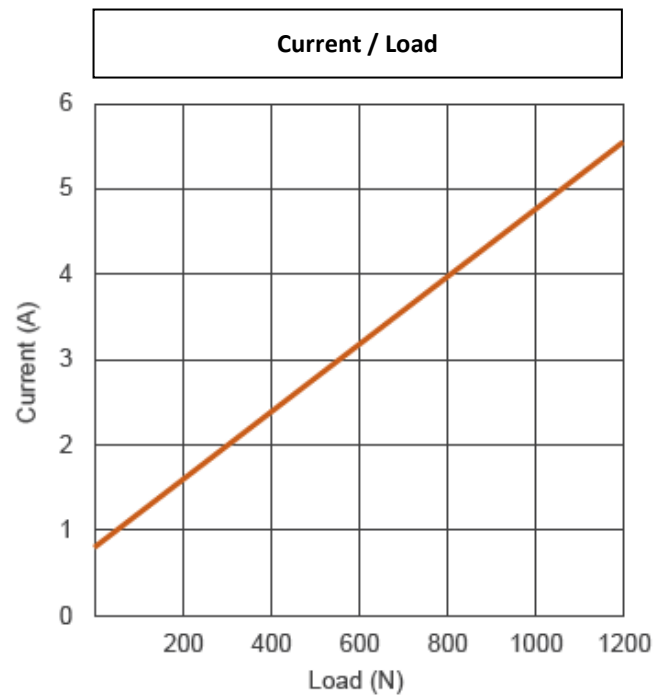
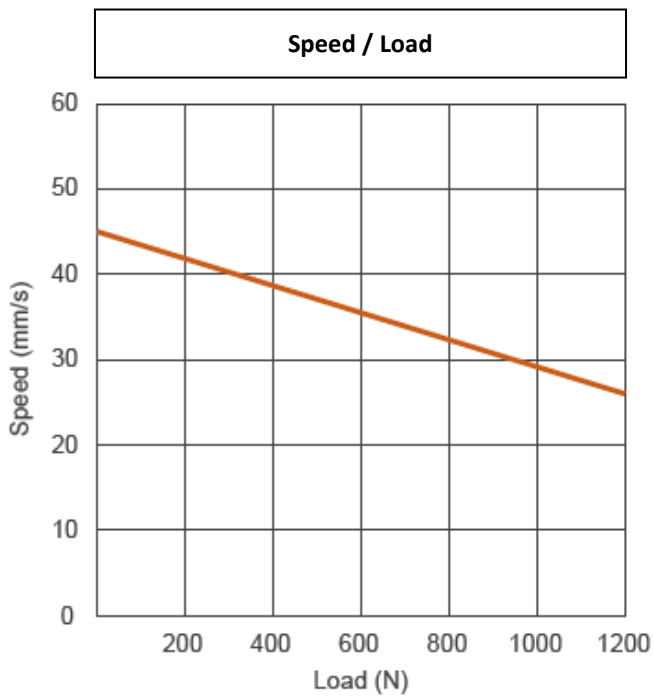

DIMENSIONS

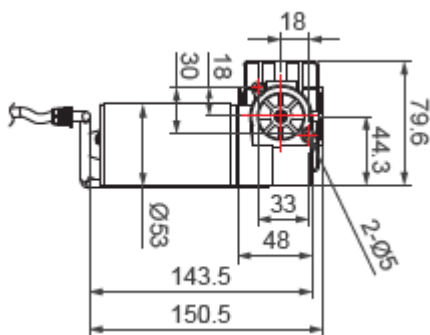
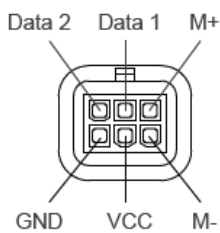

Diagram connection:



When 2 x CT3 are power-supplied by control box BCK3 then the maximum lifting capability is:
 -800 N if load put on any side (Fig. 1)
 -1200 N if load put in the center (Fig. 2)



Fig. 1



Fig. 2

