

Linear actuator V57

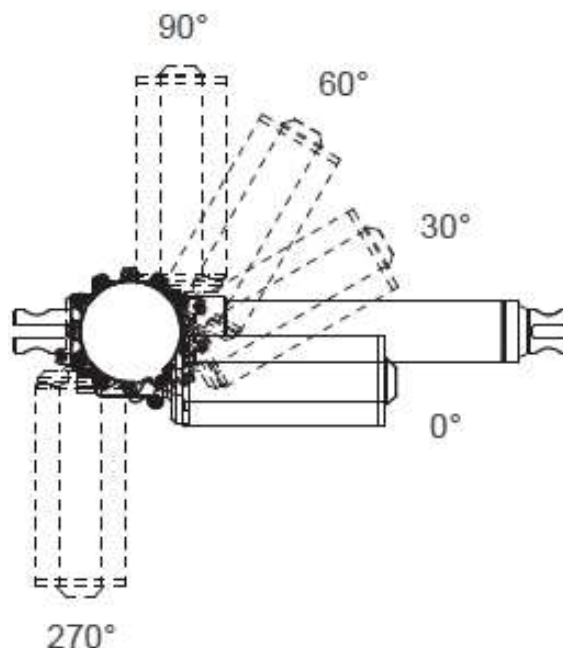

TECHNICAL SPECIFICATIONS

Motor type	12 VDC high power or 24 VDC
Force capability	-Push = maxi 4 000 N -Pull = maxi 4 000 N
Stroke	standard 50 to 300 mm and customized upon demand
Speed	-maximum 12.6 mm / sec. without load -maximum 3.5 mm/ sec. at full load (4 000 N)
Control box compatibility	-BCT / BCS1 / BCS2 / BC3T / BC4M -VeoBox (all models)
Type of cable	straight L = 250 mm
Protection grade	IP21
Motor orientation	360° in steps of every 30°
Operation temperatures	-20° to +65°
Duty cycle	10% (2 mn operation / 20 mn rest)
Colour	Black
Certification	CE marking / EMC directive 93/42/EEC

Options :

Type of cable	straight L = 750 mm
Preset cam type limit switches	to stop actuator at the end of stroke by power cut-off
Protection grade	IP66 (with waterproof housing)
Analog positioning feedback	with potentiometer
Positioning signal feedback	with 2 x Hall effect sensors

PERFORMANCES

Version	Maxi Push capability (N)	Maxi Pull capability (N)	Speed (mm/sec)		Current consumption (A)	
			Without load	At full load	Without load	At full load
V57-24K3 (24V)	4 000	4 000	4.8	3.5	0.7	3.5
V57-24K4 (24V)	3 200	3 200	6.4	4.8	0.7	3.4
V57-24K6 (24V)	2 700	2 700	9.4	7.0	0.7	3.8
V57-24K8 (24V)	2 300	2 300	12.6	8.9	0.8	4.0
V57-12W4 (12V)	4 000	4 000	12.0	9.5	3.0	16.0

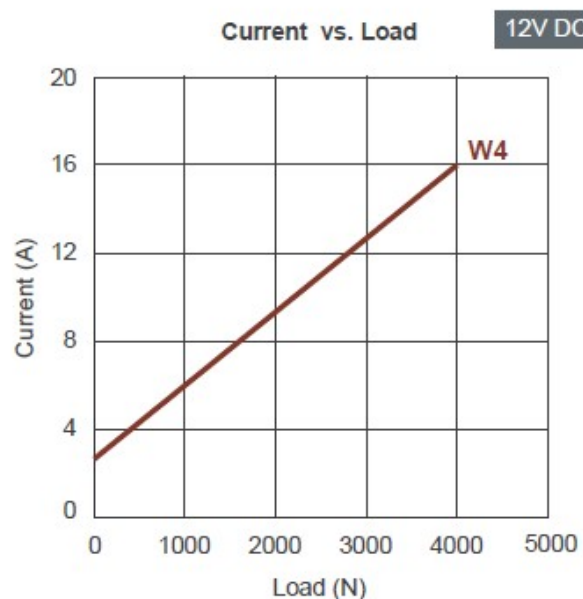
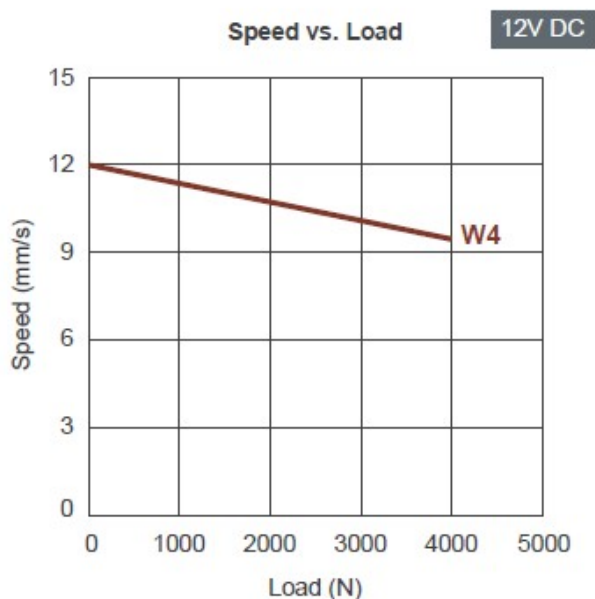
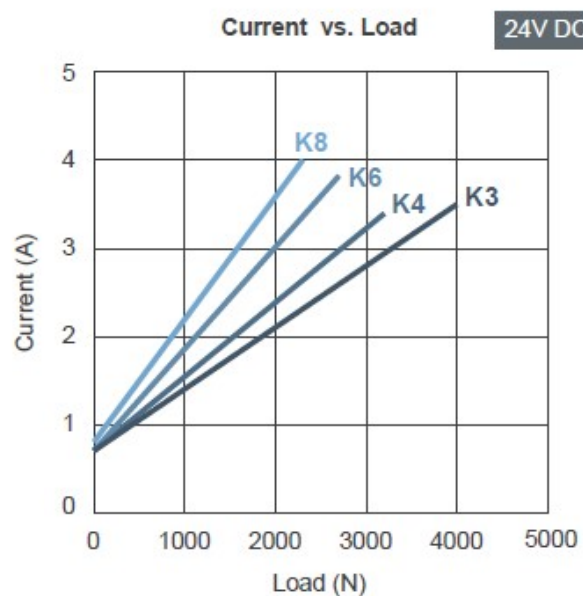
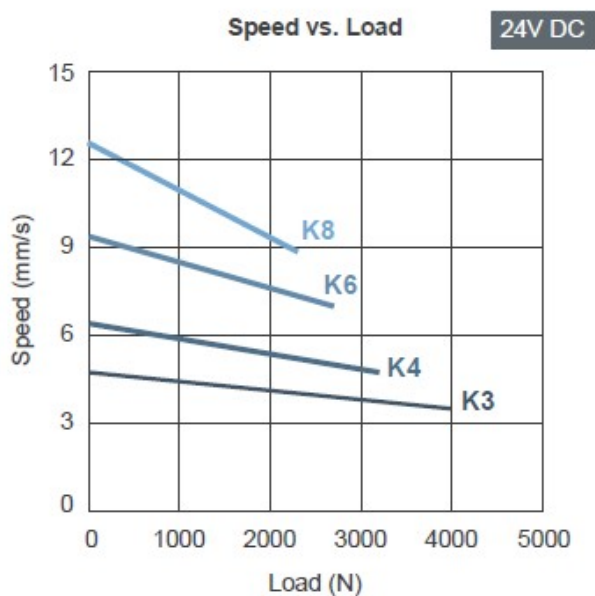

DIMENSIONS

Housings of different options

A Basic

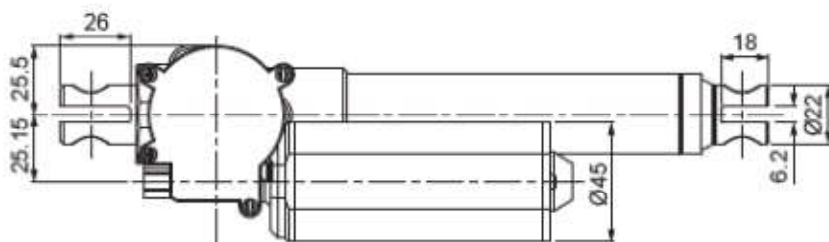
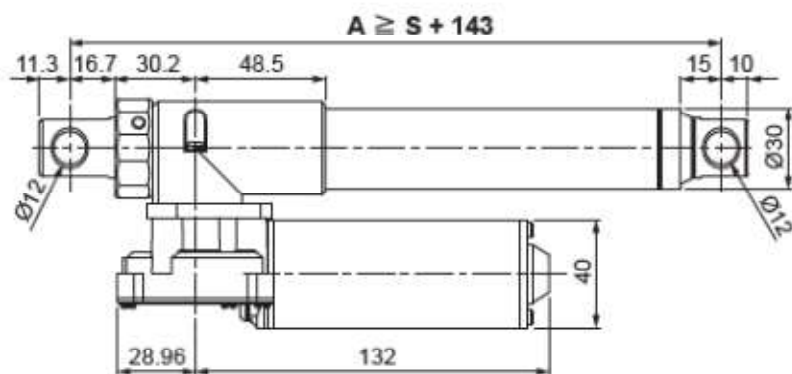
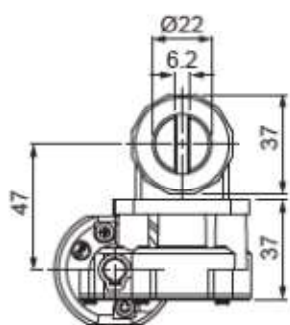

B With limit switch or positioning feedback

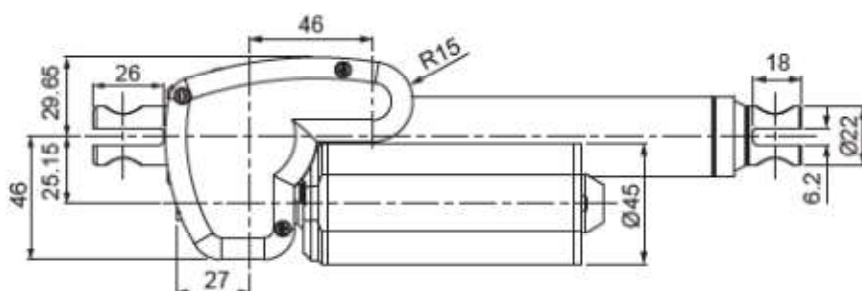
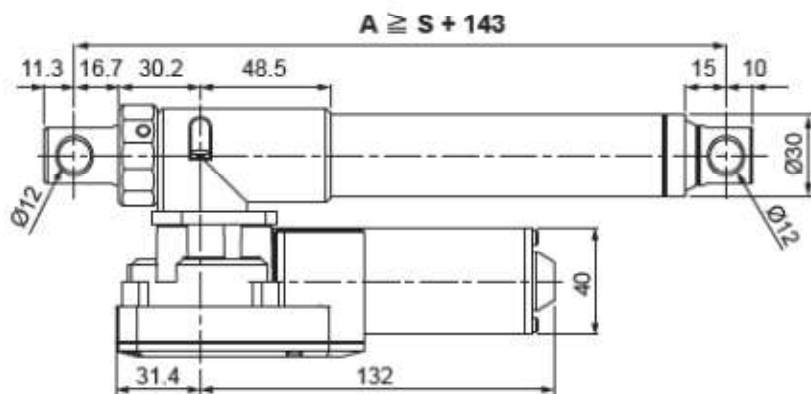
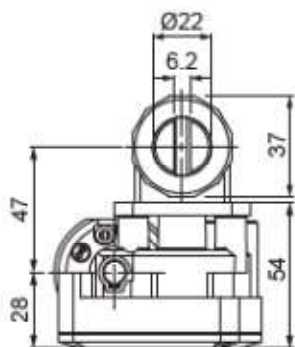

C With IPX6 waterproof case

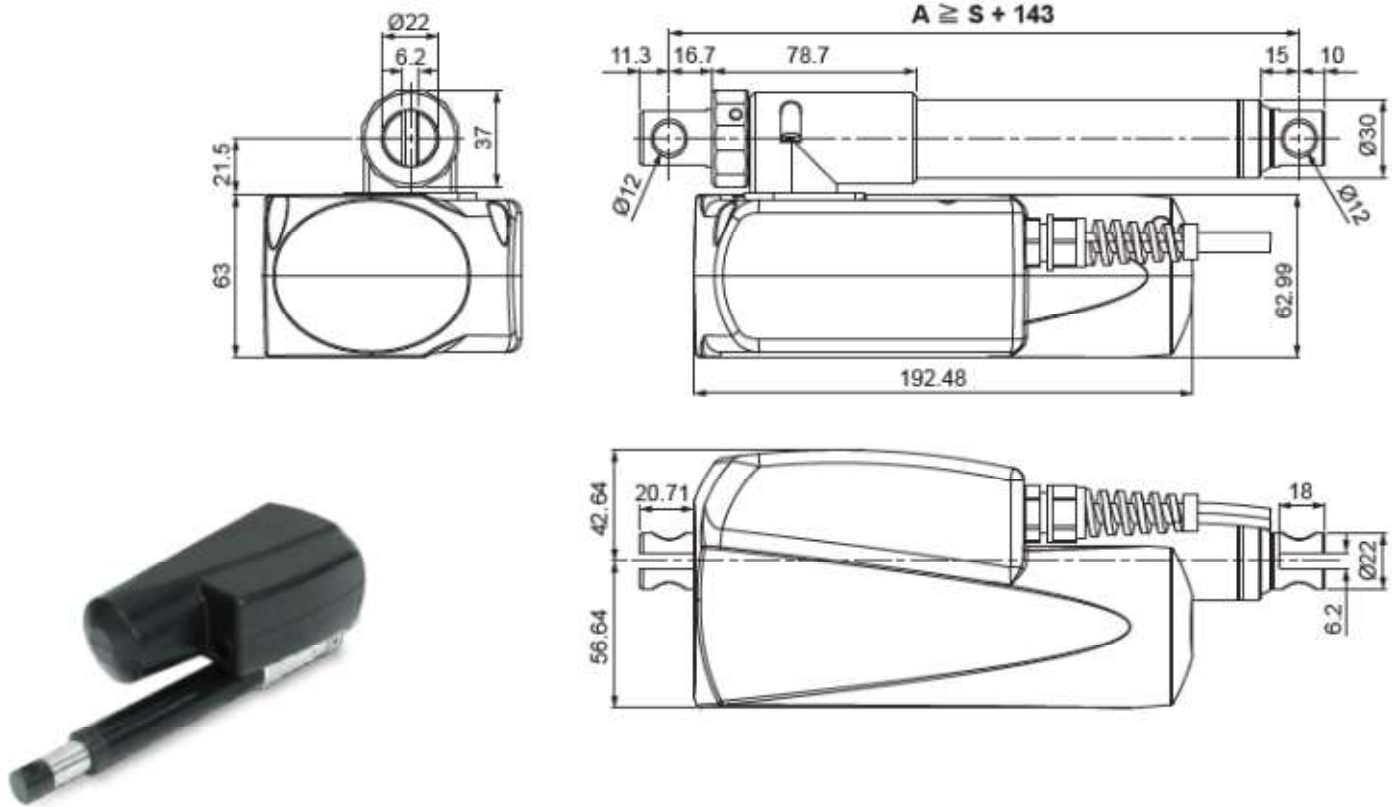

D 12V DC high power motor

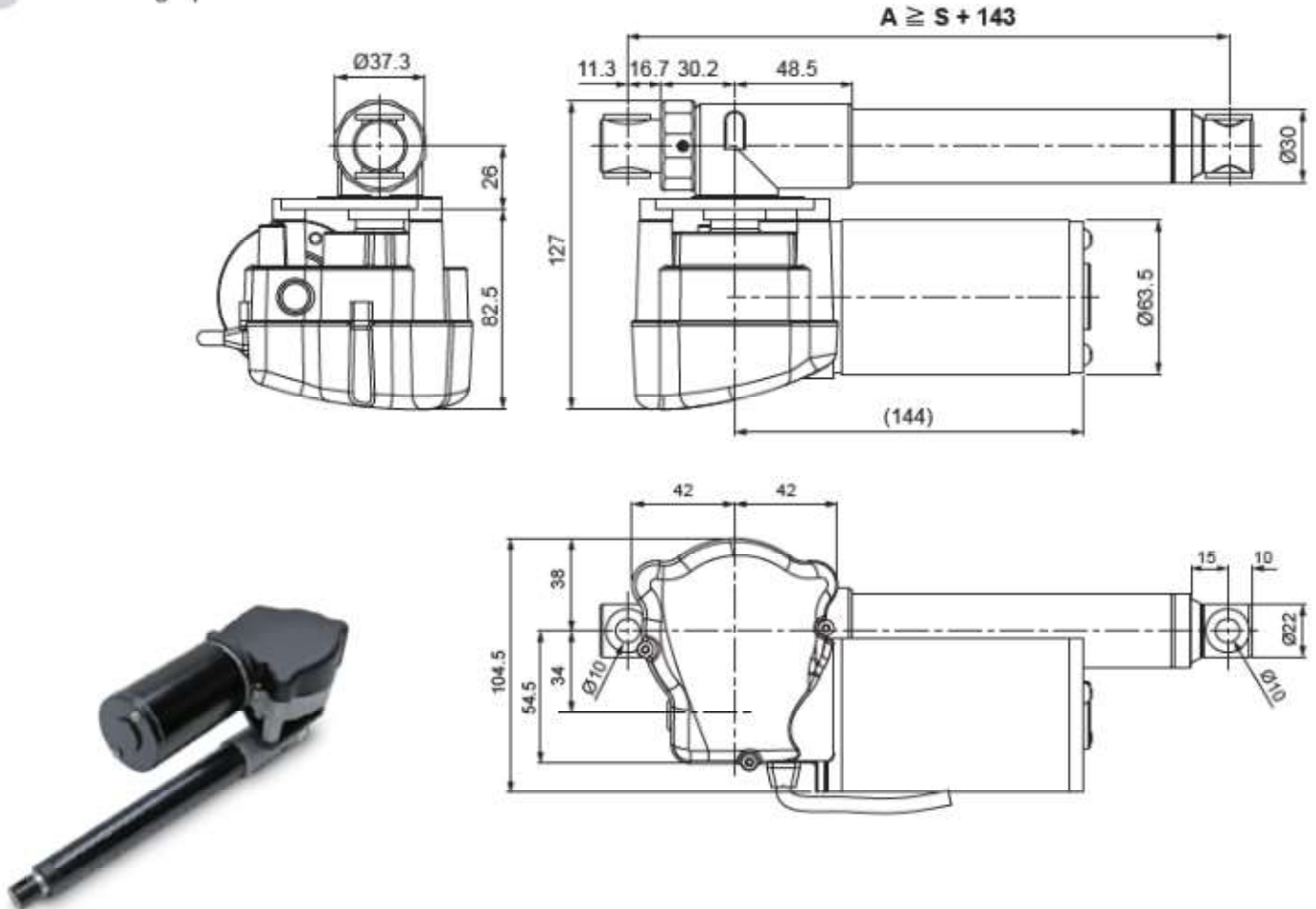

Front Connector

1: Solid with bushing

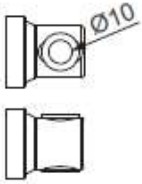

2: Solid w/o bushing

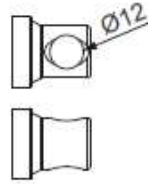

3: Slot with bushing

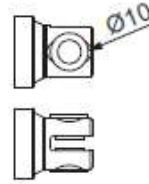

4: Slot w/o bushing

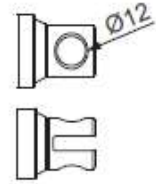

Rear Connector

1: Solid with bushing

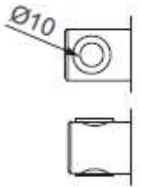

2: Solid w/o bushing

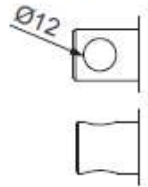

3: Slot with bushing

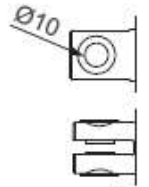

4: Slot w/o bushing

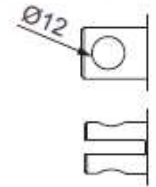

Pivot Orientation of Rear Connectors

- Solid type

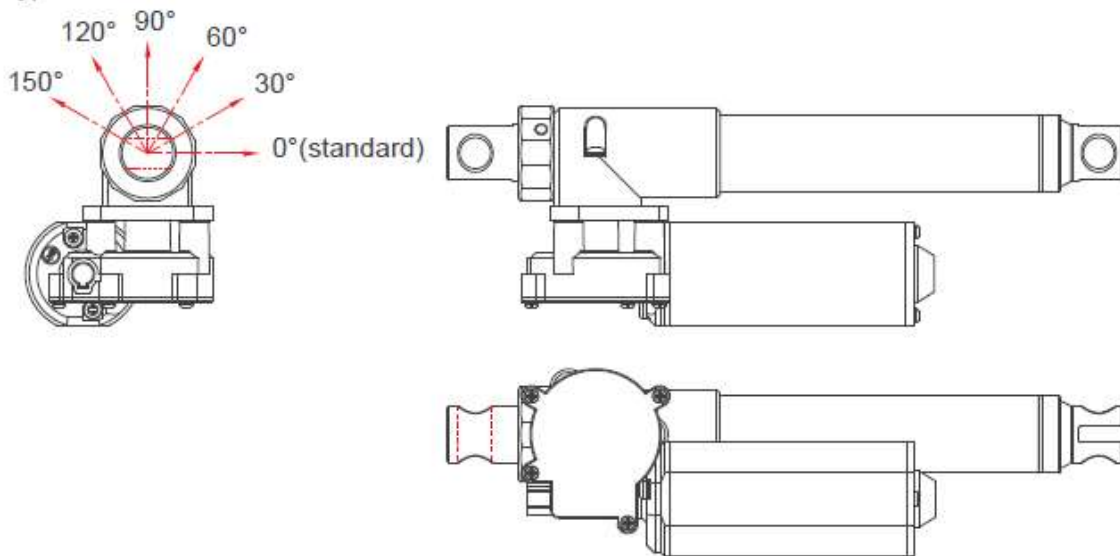

Note: Presented with solid type connector as an example in 0° orientation.

- Slot type

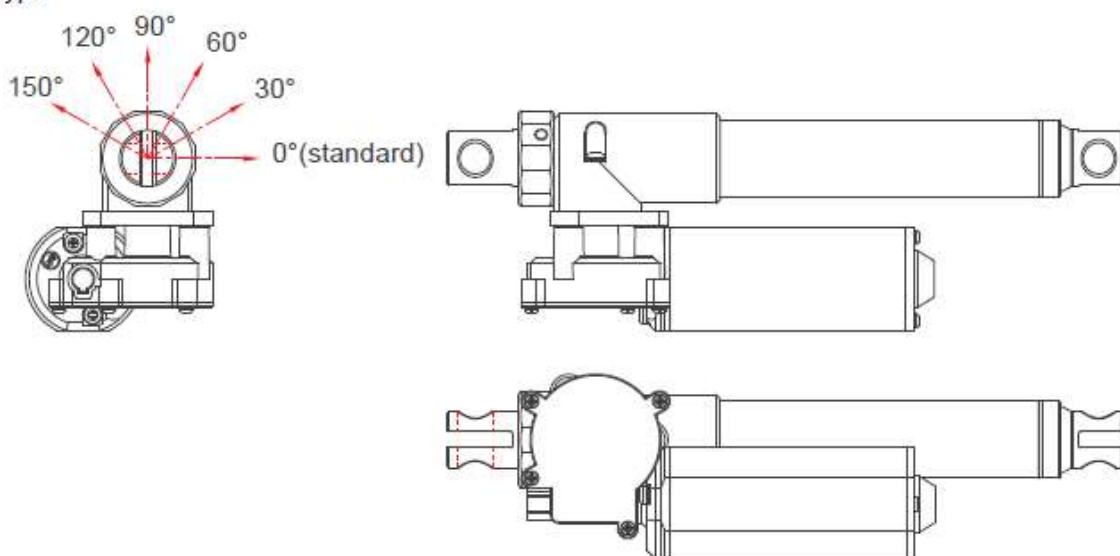

Note: Presented with slot type connector as an example in 0° orientation.