

Linear actuator V20



TECHNICAL SPECIFICATIONS

Input voltage	24 Volts DC or 12 Volts DC
Max force	Push : 2500 N Pull : 2500 N
Stroke	- 100 ~300 mm - Present limit switches
Noise level	<70dB
Speed	maximum 27 mm/sec without load maximum 4.4 mm/sec with full load
Positioning signal feedback	Hall effect sensor
IP protection level	IP65
Compatibility with control box	TB, BCS1, BCS2, BCT2, BC3T, CB4M, BC3T-SY, BC4M-S, BC4M-B
Duty cycle	25% (max. 1min continuous operation in 4min)
Ambient operation temperature	-25°C ~ +65°C
Color	Aluminium grey
Standard certifications	CE marking, EMC Directive 2014/30/EU

Options :

Positioning signal feedback	1 or 2 hall effect sensor
Analog positioning feedback	Potentiometer
Attachment	Mounting bracket (MB22)

PERFORMANCES

Model No.	Gear Ratio	Push / Pull max. (N)	Static load Max (N)	**Typical Speed (mm/s)		**Typical Current (A)	
				No load	Full load	No load	Full load
V20-24-10-G4-XXX-XXXX	10:1	500	1500	27.0	18.7	0.6	2.4
V20-24-20-G4-XXX-XXXX	20:1	1000	4500	15.1	10.7	0.5	2.3
V20-24-30-G4-XXX-XXXX	30:1	1500	4500	10.3	7.2	0.6	2.3
V20-24-40-G4-XXX-XXXX	40:1	2000	4500	7.6	5.7	0.6	2.0
V20-24-50-G4-XXX-XXXX	50:1	2500	4500	6.1	4.4	0.5	2.2

Speed vs. Load

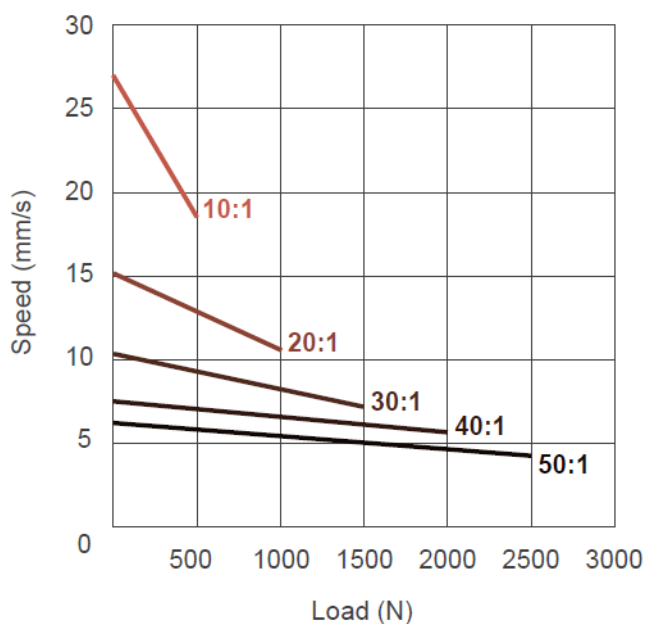

Current vs. Load

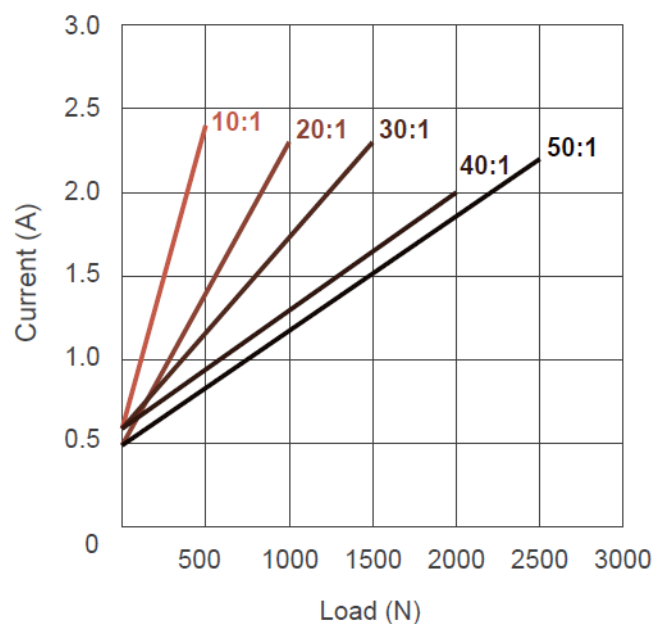

Model No.	Gear Ratio	Push / Pull max. (N)	Static load Max (N)	**Typical Speed (mm/s)		**Typical Current (A)	
				No load	Full load	No load	Full load
V20-24-10-G4-XXX-XXXX	10:1	500	1500	26.8	18.6	1.3	4.4
V20-24-20-G4-XXX-XXXX	20:1	1000	4500	14.7	10.4	1.1	4.6
V20-24-30-G4-XXX-XXXX	30:1	1500	4500	9.9	6.8	1.0	4.3
V20-24-40-G4-XXX-XXXX	40:1	2000	4500	7.4	5.1	1.0	4.5
V20-24-50-G4-XXX-XXXX	50:1	2500	4500	6.2	4.4	0.9	4.1

Speed vs. Load

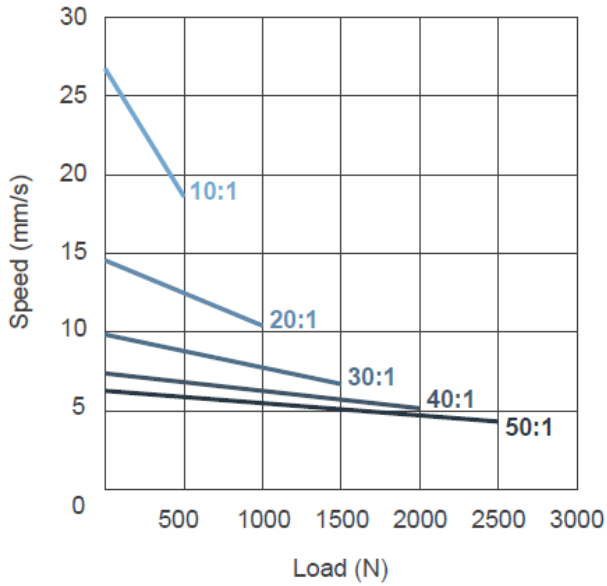

Current vs. Load

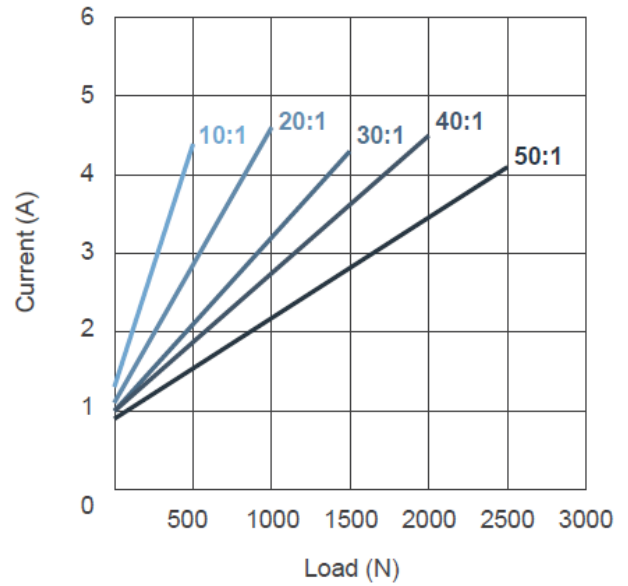

DIMENSIONS

Standard					
Stroke (S)	100 (4")	150 (6")	200 (8")	250 (10")	300 (12")
Retracted Length (A)	205	255	305	355	405

(tolerance: ±3mm)

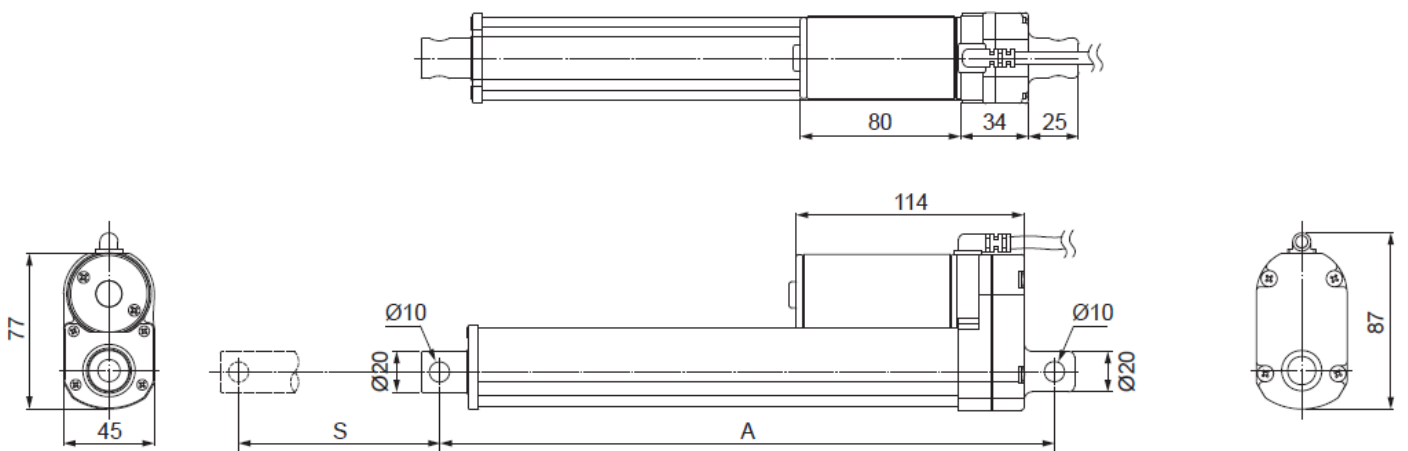

With Potentiometer (POT)					
Stroke (S)	100 (4")	150 (6")	200 (8")	250 (10")	300 (12")
Retracted Length (A)	242	292	342	392	442

(tolerance: ±3mm)

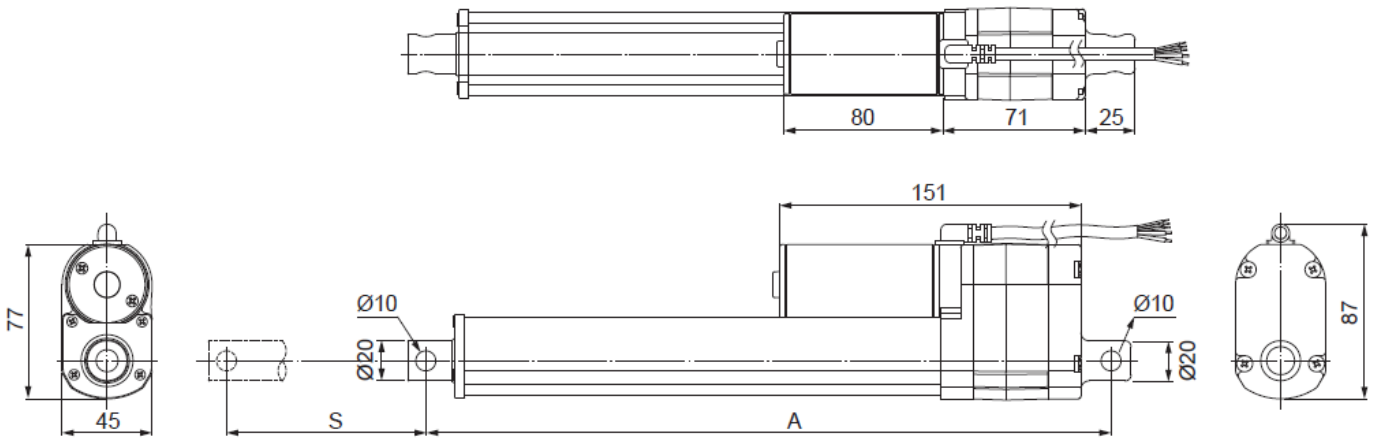

Front connector

- Drilled hole

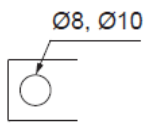

Rear connector

- Drilled hole

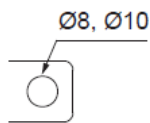

Mounting bracket (MB22)

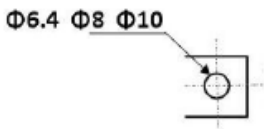
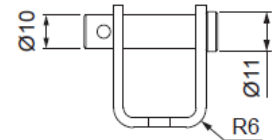
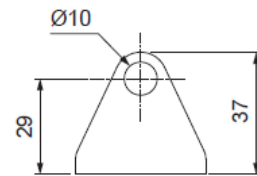
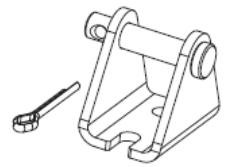
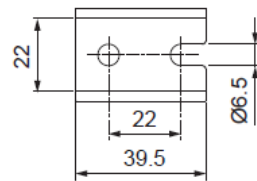

Front clevis

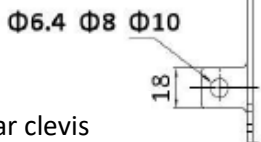
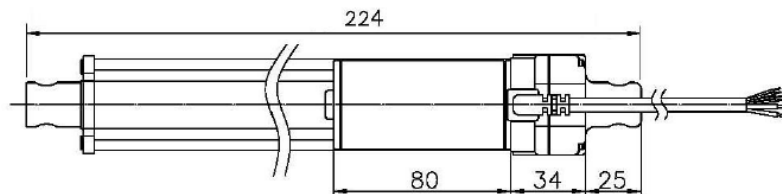

Rear clevis

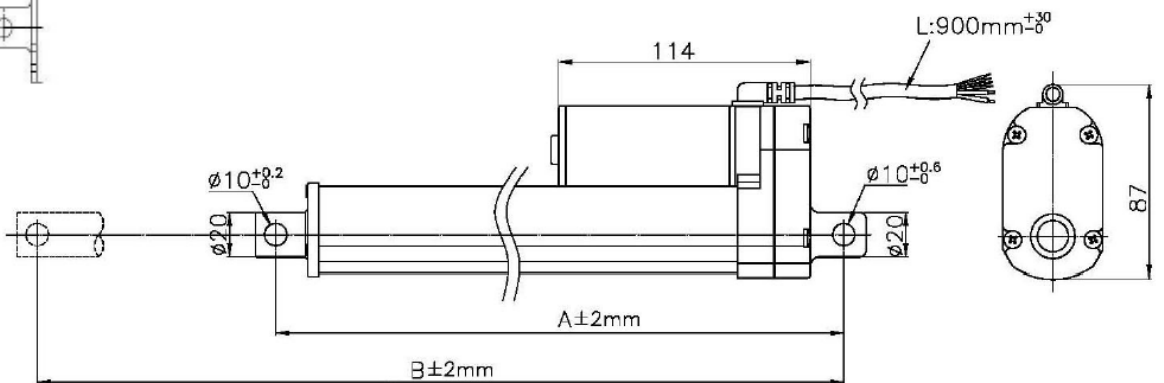
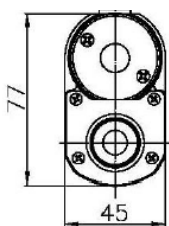

Unit = mm