



TECHNICAL SPECIFICATIONS

Motor type	24 Volts DC or 12 Volts DC
Maximum strength	-Push : 6000 N -Pull : 4000 N
Strokes	-Standard 50 ~ 300m or tailor-made -Preset limit switches
Speed	-Speed at no load: 33.3 mm/sec -Speed at full load: 2.9 mm/se
Noise level	≤50 dB
Protection grade	IP42
Operating temperatures	-20° to +65°
Duty cycle	10% (2 mn operation/ 120 mn rest)
Control boxes compatibility	TES / TB / BCTR / BCS1 / BCS2 / BC3T / BC4M / NOVOMAT
Colour	Black
Certifications	CE Marking / EMC Directive 2014/30/EU

Options:

Positioning signal feedback	1 or 2 Hall effect sensor
Push Only function	Mechanical on extension tube
Pivot orientation rear connector	90° pivot

PERFORMANCES

Model	Push max. (N)	Pull max. (N)	*Self-locking ability (N)	**Typical speed (mm/s)		**Typical current (A)			
				No load	Full load	No load		Full load	
						12V	24V	12V	24V
V1-XX-A4	6 000	4 000	5 000	4.2	2.9	0.8	0.6	5.4	2.7
V1-XX-A6	4 000	4 000	2 500	6.2	3.8	0.4	0.6	6.0	3.0
V1-XX-A8	3 000	3 000	2 000	8.3	5.0	0.6	0.6	5.4	2.7
V1-XX-AG	1 500	1 500	700	16.6	12.2	0.4	0.6	5.6	2.8
V1-XX-KG	750	750	0	33.3	23.5	0.4	0.6	5.2	2.7
V1-XX-F4	5 000	4 000	5 000	5.5	4.4	0.8	0.6	5.6	2.8
V1-XX-F8	3 000	3 000	2 000	11.0	8.2	1.0	0.6	5.8	2.9

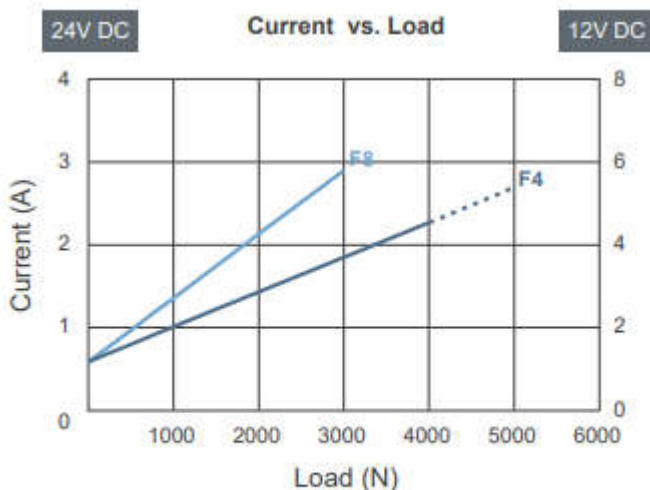
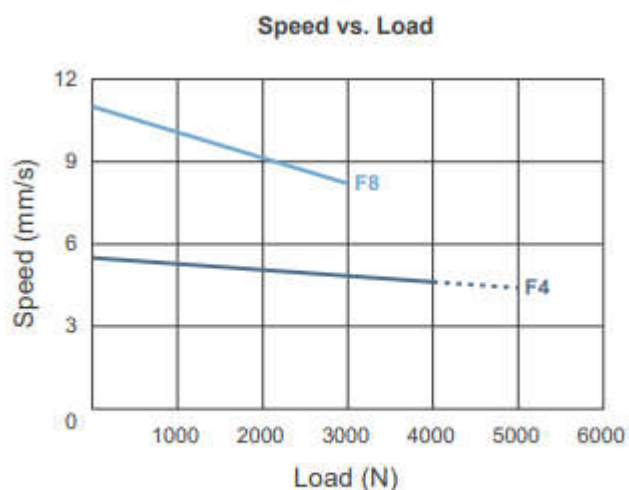
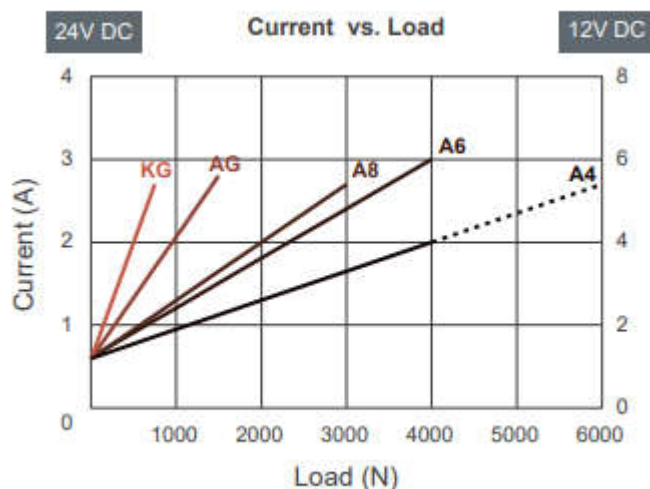
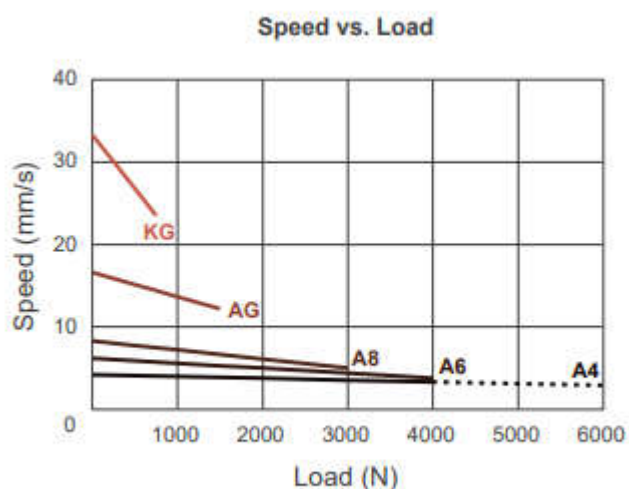

Push / Pull Load — Push Load - - -

Remarks:

*The self-locking ability is performed by short circuit the motor terminals when the actuator is powered off.

All compatible control boxes are designed with this feature. Mechanical brake in push direction is available upon request, to further enhance the self-locking ability to maximum load.

**The typical speed or typical current means the average value neither upper limit nor lower limit. The performance curves are made with typical values.

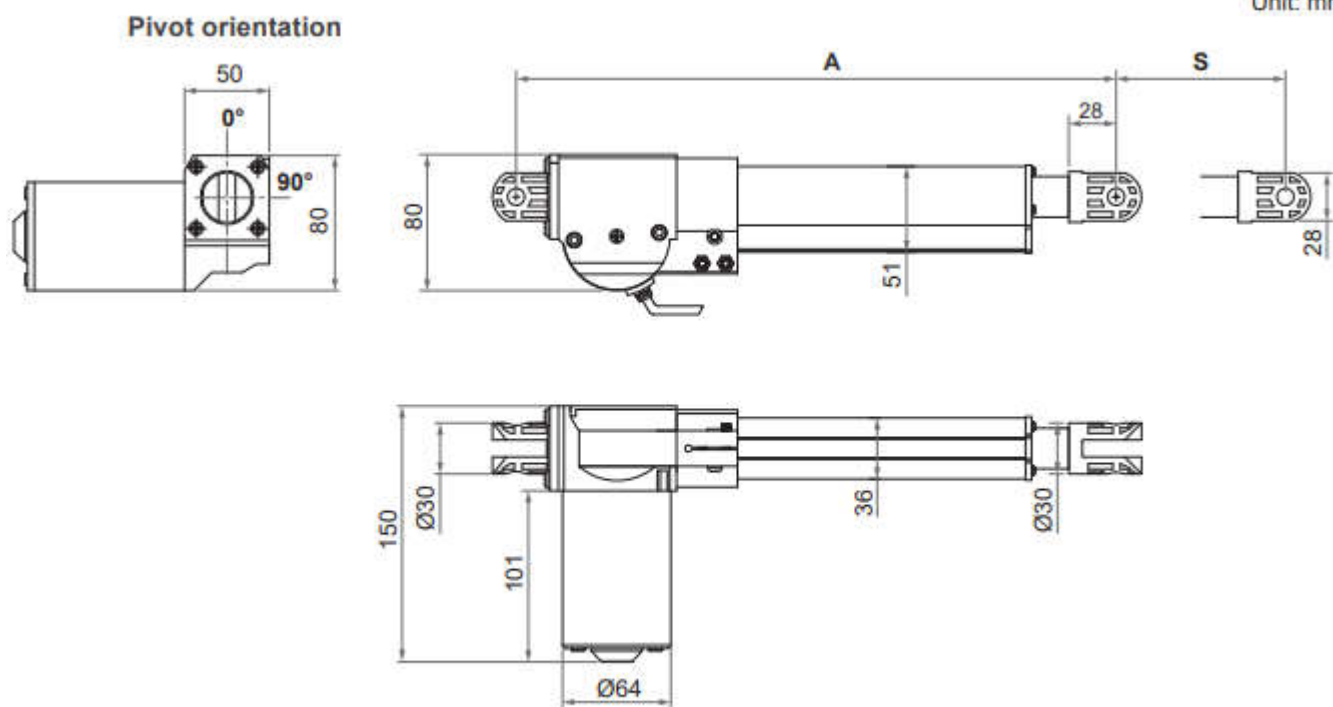

Note: As an example in 0° orientation for rear connector.

Direct-Cut cable DL2

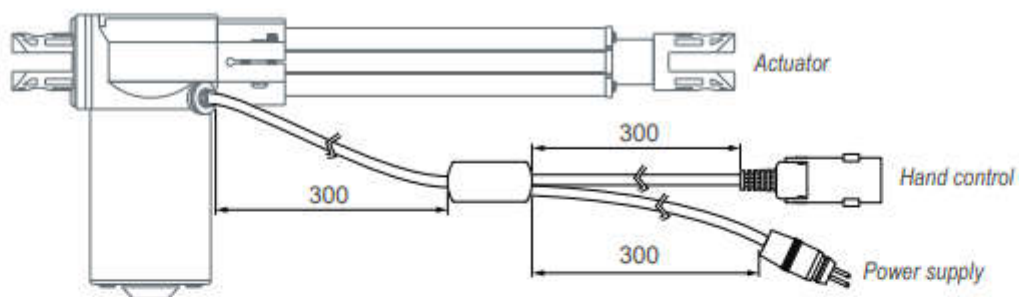

Direct-Cut cable TL2

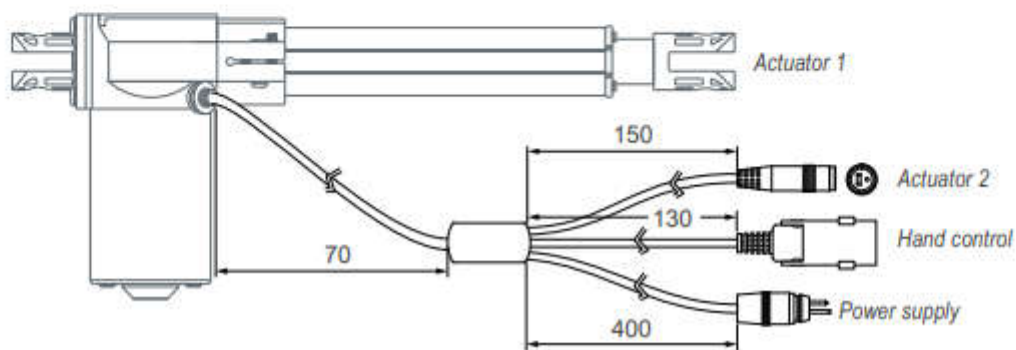

Installation Dimension

• Retracted length (A)

Front connector code	Rear connector code	Retracted length (A)
1, 5, 8	1, 2	$A \geq S+188\text{mm} (\pm 3\text{mm})$
2, 3, 7		$A \geq S+160\text{mm} (\pm 3\text{mm})$
1, 5, 8	5 (with crank function)	$A \geq S+198\text{mm} (\pm 3\text{mm})$
2, 3, 7		$A \geq S+170\text{mm} (\pm 3\text{mm})$

Available stroke (S) range = 50 ~ 300 mm

Extended length = S + A

• Front connector

1: Plastic

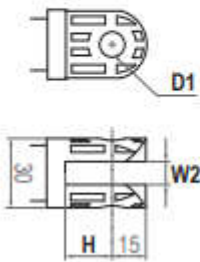

2: Drilled hole with brass bushing

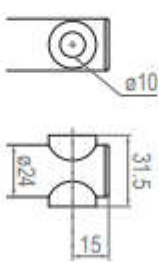

3: Drilled hole

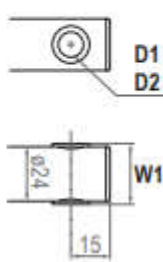

5: Metal

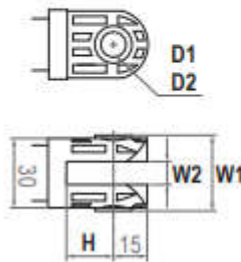

7: Drilled hole with nylon bushing

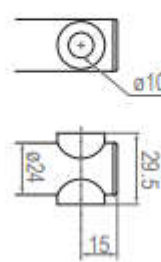

8: Enhanced metal

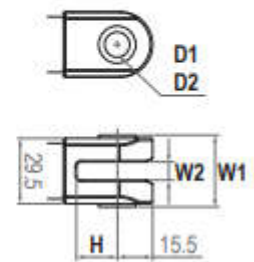

Front connector code	Diameter of pivot without bushing (D1)	Diameter of pivot with bushing (D2)	Width with bushing (W1)	Slot width (W2)	Slot depth (H)
1	$\phi 8, \phi 10, \phi 12$	N/A	N/A	10	20
2	N/A	N/A	N/A	N/A	N/A
3	$\phi 8, \phi 10, \phi 12, \phi 14$	$\phi 8, \phi 10$	26	N/A	N/A
5	$\phi 8, \phi 10, \phi 12$	$\phi 8, \phi 10$	32	10	20
7	N/A	N/A	N/A	N/A	N/A
8	$\phi 10, \phi 12$	$\phi 8, \phi 10$	31.5	8	19.5

• Rear connector

1: Plastic

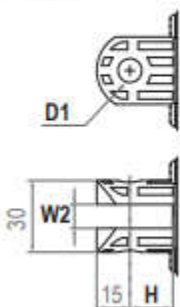

2: Metal



5: Metal (with crank function)

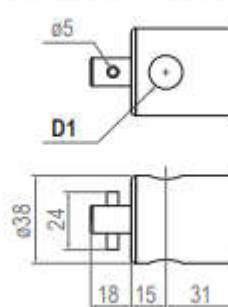

Rear connector code	Diameter of pivot without bushing (D1)	Diameter of pivot with bushing (D2)	Width with bushing (W1)	Slot width (W2)	Slot depth (H)
1	$\phi 8, \phi 10, \phi 12$	N/A	N/A	6, 10	17
2	$\phi 8, \phi 10, \phi 12$	$\phi 8, \phi 10$	32	6, 10	17
5	$\phi 14.5$	N/A	N/A	N/A	N/A

CABLE PLUG

With F-type or L3-type plug (required to be connected to the control box):

- Without Hall effect sensor

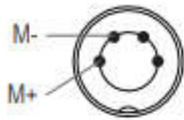

F-type 4-pin DIN plug

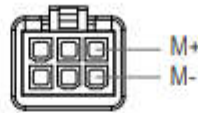

L3-type Minifit 6-pin plug

F-type

- With dual Hall effect sensors

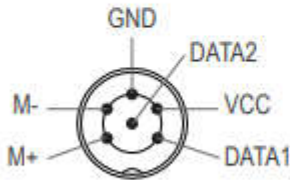

F-type 6-pin DIN plug

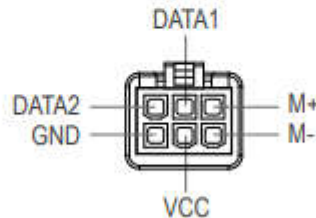

L3-type Minifit 6-pin plug

L3-type

Note: Connect Pin (M+) to "+" & Pin (M-) to "-" of DC power, the actuator will extend.

With Direct-Cut cable DL2 or TL2 (NOT required to be connected to any control box):

- Hand control connector: with Moteck U-type female connector

1 drive

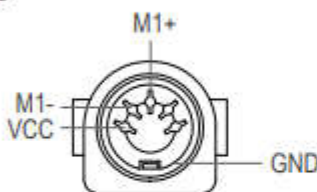

5-pin connector
(Moteck pinout: C-DIN-51H)

2 drives

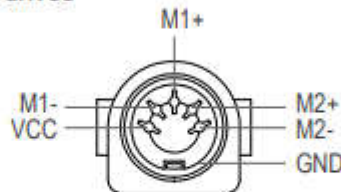

5-pin connector
(Moteck pinout: C-DIN-52H)



U-type

Note: Connect pin (M1+) to "+" & pin (M1-) to "-" of DC power, the M1 actuator will extend. Definition of M2 actuator is the same.

- Power plug: with Moteck R-type male plug



DIN 41529 plug



R-type

- Connector for 2nd actuator: with Moteck R-type female connector (for TL2 only)



DIN 41529 connector



R-type